

REPAIR PARTS LIST
LISTE DE PIÈCES
DE RECHANGE
LISTA DE
REQUERIDOS

MJS Series
Self Priming Shallow Well Jet Pumps
Pompes à jet auto-amorçante pour
puits peu profond
Bombas Autocebantes a Presion
Para pozos de baja Profundidad

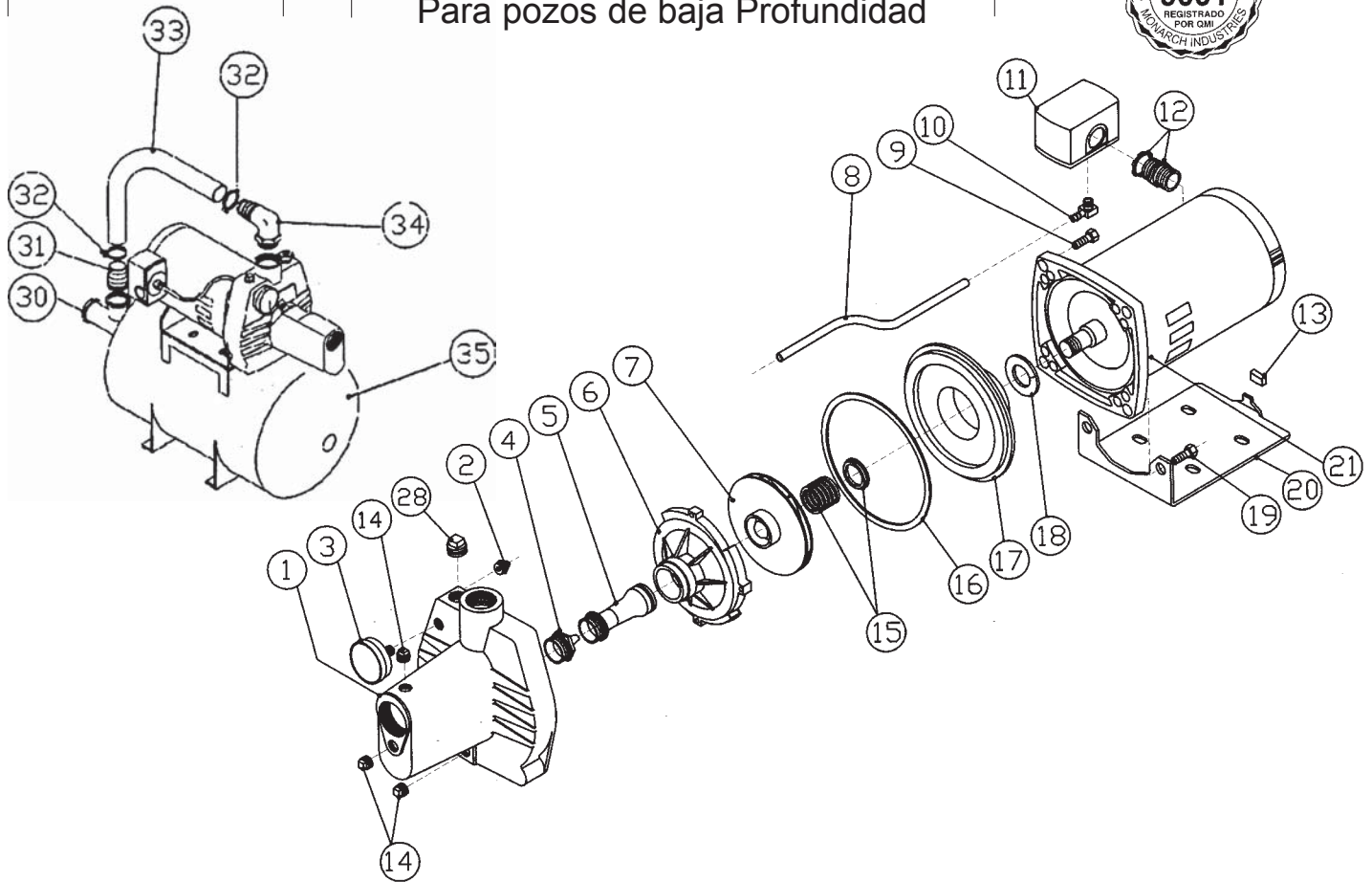

| Ref # | Code # | 1/3HP | 1/2HP | 3/4HP | 1/2HP High Pressure | 1 HP | Description | Description | Descripción |
|-------|--------|-------|-------|-------|---------------------------|------|------------------------|--------------------------|-------------------------------|
| 1 | 469308 | 1 | 1 | 1 | 1 | 1 | Casing - Blue | Boîtier - bleu | Caja/caso - azul |
| 2 | 200970 | 1 | 1 | 1 | 1 | 1 | Mini Barb fitting male | Raccord mâle | Mini-lengüeta macho de acople |
| 3 | 633652 | 1 | 1 | 1 | 1 | 1 | Pressure Gauge | Manomètre | Manómetro de Presión |
| 4 | 247290 | 1 | 1 | | 1 | | Nozzle | Bec | Boquilla |
| | 247292 | | | 1 | | | Nozzle | Bec | Boquilla |
| | 469022 | | | | | 1 | Nozzle | Bec | Boquilla |
| 5 | 247284 | 1 | | | | | Venturi | Venturi | Venturi |
| | 247286 | | 1 | | | | Venturi | Venturi | Venturi |
| | 247287 | | | 1 | | | Venturi | Venturi | Venturi |
| | 247283 | | | | 1 | | Venturi | Venturi | Venturi |
| | 247289 | | | | | 1 | Venturi | Venturi | Venturi |
| 6* | 246233 | 1 | 1 | 1 | 1 | 1 | Diffuser | Diffuseur | Difusor |
| 7* | 469095 | 1 | | | | | Impeller | Roue de turbine | Turbina |
| | 246251 | | 1 | | | | Impeller | Roue de turbine | Turbina |
| | 246236 | | | 1 | 1 | 1 | Impeller | Roue de turbine | Turbina |
| 8 | 467820 | 1 | 1 | 1 | 1 | 1 | Tube, Polyethylene | Tube en polyéthylène | Tubo, Polietileno |
| 9 | 120020 | 2 | 2 | 2 | 2 | 2 | Bolt, 3/8 UNC x 1-1/4 | Boulon, 3/8 UNC x 1-1/4 | Tornillo, 3/8 UNC x 1-1/4 |
| 10 | 200990 | 1 | 1 | 1 | 1 | 1 | Minibarb Elbow | Coude de mini-cannelures | codo de minibarb |

| Ref# | Code# | 1/3HP | 1/2HP | 3/4HP | 1/2HP High Pressure | 1 HP | Description | Description | Descripción |
|------|--------|-------|-------|-------|---------------------------|------|----------------------------|-------------------------------|------------------------------------|
| 11 | 224228 | | | | | | Pressure Switch | Manostat | Interruptor de Presión |
| 12 | 112511 | 1 | 1 | 1 | 1 | 1 | Conduit Nipple 1/2" | Mamelon du Conduit 1/2" | Rosquilla de Conducto 1/2" |
| 13 | 246801 | 1 | 1 | 1 | 1 | 1 | End Cap | | |
| 14 | 185620 | 3 | 3 | 3 | 3 | 3 | Plug, 1/4 NPT | Bouchon, 1/4 NPT | Tapón, 1/4 NPT |
| 15* | 240160 | 1 | 1 | 1 | 1 | 1 | Seal, 5/8 Dia. | Joint diamètre de 5/8 | Sello, 5/8 Diámetro |
| 16* | 192785 | 1 | 1 | 1 | 1 | 1 | Gasket | Joint | Junta |
| 17 | 469147 | 1 | 1 | 1 | 1 | 1 | Seal Plate | Plaque de joint | Sello de Base |
| 18 | 191790 | 1 | 1 | 1 | 1 | 1 | Flinger | Cavalier | Arranque |
| 19 | 120030 | 2 | 2 | 2 | 2 | 2 | Bolt, 3/8 UNC x 1-1/2 | Boulon, 3/8 UNC x 1-1/2 | Tornillo, 3/8 UNC x 1-1/2 |
| 20 | 438245 | 1 | 1 | 1 | 1 | 1 | Base Plate | Plaque de base | Lámina |
| 21 | 204071 | 1 | | | | | Mot. 1/3 HP 115V Split PH. | Moteur 1/3 CV 115V | Motor 1/3 CV 115V |
| | 204073 | | 1 | | | | Mot. 1/2HP 115/230V Cap | Moteur 1/2 CV 115/230V Cap | Motor 1/2 CV 115/230V Cap |
| | 204125 | | | 1 | | | Mot. 3/4 HP 115/230V Cap | Moteur 3/4 CV 115/230V Cap | Motor 3/4 CV 115/230V Cap |
| | 204154 | | | | | 1 | Mot. 1 HP 115/230V Cap | Moteur 1 CV 115/230V Cap | Motor 1 CV 115/230V Cap |
| 28 | 185640 | 1 | 1 | 1 | 1 | 1 | Plug, 1/2 NPT | Bouchon, 1/2 NPT | Tapón, 1/2 NPT |
| N/S | 497150 | 1 | | | | | Minor Overhaul Kits | Trousse de réparation mineure | Conjuntos para Reparaciones |
| | 497151 | | 1 | | | | (Includes; 7, 15 & 16) | (Inclué; 7, 15 et 16) | Menores (Incluye; 7, 15 et 16) |
| | 497152 | | | 1 | | | | | |
| | 497158 | | | | 1 | | | | |
| | 497153 | | | | | 1 | | | |
| N/S | 497154 | 1 | | | | | Major Overhaul Kits | Trousse de réparation majeur | Conjuntos para Reparaciones |
| | 497155 | | 1 | | | | (Include; 6, 7, 15, & 16) | (Inclué; 6, 7, 15, et 16) | Mayores (Incluye; 6, 7, 15, et 16) |
| | 497156 | | | 1 | | | | | |
| | 497159 | | | | 1 | | | | |
| | 497157 | | | | | 1 | | | |
| N/S | 497164 | 1 | | | | | Major Overhaul Kits | Trousse de réparation majeur | Conjuntos para Reparaciones |
| | 497165 | | 1 | | | | (Include; 6, 7, 15, & 16) | (Inclué; 6, 7, 15, et 16) | Mayores (Incluye; 6, 7, 15, et 16) |
| | 497166 | | | 1 | | | | | |
| | 497167 | | | | 1 | | | | |
| | 497169 | | | | | 1 | | | |

System Parts / Pièces de système / Piezas de sistema

MONARCH Models/Modèles/Modelos: a = MJS-50/JR15S b = MJS-50/JR25S

| Ref.# | Code# | a | b | Description | Description | Descripción |
|-------|--------|---|---|---------------------------------------|--|--|
| 30 | 189200 | 1 | 1 | Tee, 3/4" x 3/4" x 3/4" | Raccord en T, 3/4 po x 3/4 po x 3/4 po | T para el tanque 3/4 x 3/4 x 3/4 pulg. |
| 31 | 179200 | 1 | 1 | 3/4" NPT x 1" Hose Adaptor | Adaptateur de boyau 3/4 po NPT x 1 po | Adaptador de manguera 3/4 NPT x 1 pulg |
| 32 | 116710 | 2 | 2 | Clamp | Collier de serrage | Abrazadera |
| 33 | 469222 | 1 | | Hose-Water 1" x 24" Long | Tuyau - Eau 1 po x 24 po Long | Manguera para agua 1 x 24 pulg. largo |
| 33 | 469223 | | 1 | Hose-Water 1" x 26" Long | Tuyau - Eau 1 po x 26 po Long | Manguera para agua 1 x 26 pulg. largo |
| 34 | 189201 | 1 | 1 | 90° Elbow 1" NPT x 1" Hose Adaptor | Adaptateur de tuyau coudé, 90°, 1 po NPT x 1 po | Codo de 90° adaptador de manguera 1 NPT x 1 pulg. |
| 35 | 604501 | 1 | | Precharged Tank 4.5 U.S. gal. | Réservoir préchargé 4.5 gal/U.S. | Tanque precargado 4.5 gal/U.S. |
| 35 | 604502 | | 1 | Precharged Tank 8.5 U.S. gal. | Réservoir préchargé 8.5 gal/U.S. | Tanque precargado 8.5 gal/U.S. |

*Suggested parts to stock
IMPORTANT; When ordering parts specify the
Model, Code number and Part Description.

*Suggestion de pièces de rechange à entreposer.
IMPORTANT: Les commandes de pièces doivent spécifier
le Modèle, le Numéro de code et sa Description.

*Repuestos que se sugiere almacenar
IMPORTANTE: Cuando haga el pedido de los
repuestos, especifique el modelo, número de
Código y la descripción del repuestos.

MONARCH INDUSTRIES